

1.0mm Male RF Termination Load | DC–110GHz, 1W | Precision Microwave Dummy Load

P/N: FR3-1.0-J-03

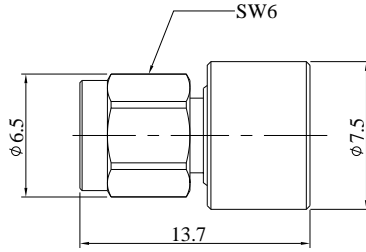

Dimensions are in mm



Product Configuration Cable

Connector Series	1.0mm
Connector Polarity	Standard
Connector Gender	Male
Connector Impedance (Ohm)	50

Electrical Specifications

Frequency	DC - 110GHz
VSWR / Return Loss	1.6
Power, Max Input (Watts)	1

Mechanical Data

Min. Mating Cycles	≥ 500
Body Material	Stainless Steel
Body Plating	Passivated

Environmental Specifications

RoHS Compliant	Yes
Operating Temperature Range	-55 °C to +125 °C

Test Report

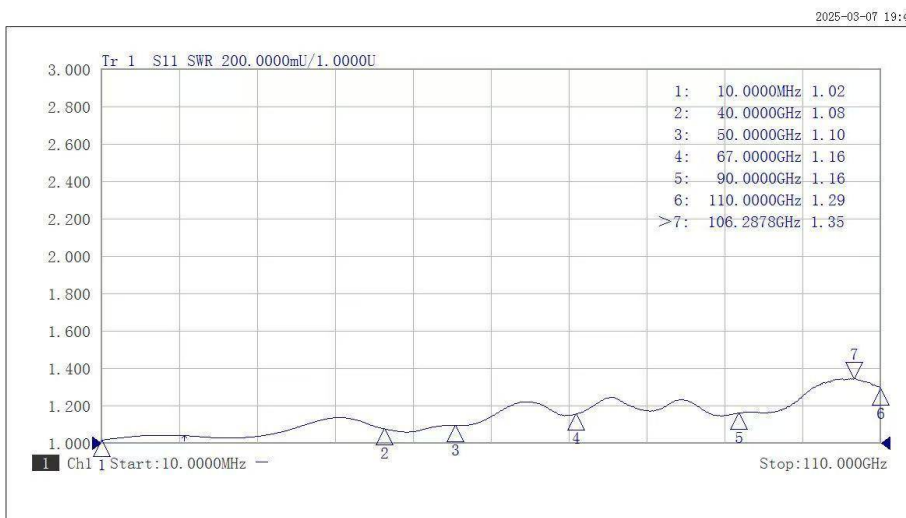

1.0mm Female RF Termination Load | DC–110GHz, 1W | Precision Microwave Dummy Load

P/N: FR3-1.0-K-03

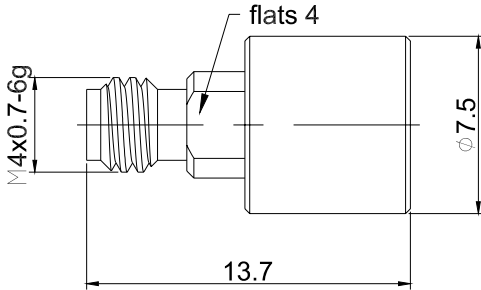

Dimensions are in mm



Product Configuration Cable

Connector Series	1.0mm
Connector Polarity	Standard
Connector Gender	Female
Connector Impedance (Ohm)	50

Electrical Specifications

Frequency	DC - 110GHz
VSWR / Return Loss	1.6
Power, Max Input (Watts)	1

Mechanical Data

Min. Mating Cycles	≥ 500
Body Material	Stainless Steel
Body Plating	Passivated

Environmental Specifications

RoHS Compliant	Yes
Operating Temperature Range	-55 °C to +125 °C

Test Report

