

## GPO(SMP) Female RF Load Termination Up To 40 GHz | 1 Watts | Gold Plated Beryllium Copper

P/N: FR3-GPO-K-03

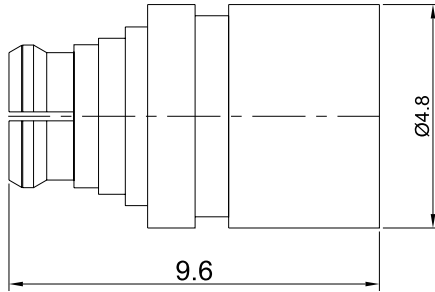

Dimensions are in mm

### Product Configuration Cable

Connector Series	GPO(SMP)
Connector Polarity	Standard
Connector Gender	Female
Connector Impedance (Ohm)	50

### Electrical Specifications

Frequency	DC -40GHz
VSWR / Return Loss	1.2 to 18GHz, 1.4 to 40GHz
Power, Max Input (Watts)	1

### Mechanical Data

Min. Mating Cycles	≥500
Weight	0.75 g
Body Material	Beryllium Copper
Body Plating	Gold
Cryogenic	No
Non-Magnetic	No

### Environmental Specifications

RoHS Compliant	Yes
Operating Temperature Range	-55 °C to +125 °C
MIL/STD	N/A

### Test Report

